

DEF STAN 59-411

Military Test Chamber

Product Features

Due to the various dimensions and requirements of the equipment under test (EUT), all DEF STAN 59-411 chambers are designed and manufactured to exact requirements.

Test facility for performing compliant test to DEF STAN 59-411, MIL-STD461 and RTCA DO-160. The chamber can be designed to test small electronic equipment through to very large military vehicles. Communication and electrical equipment, armaments, aircraft equipment and vehicles are all examples of that can be tested.

Global EMC's DEF STAN shielded test facility uses GF 102 ferrite tile and high-performance pyramidal Hybrid Absorbers.

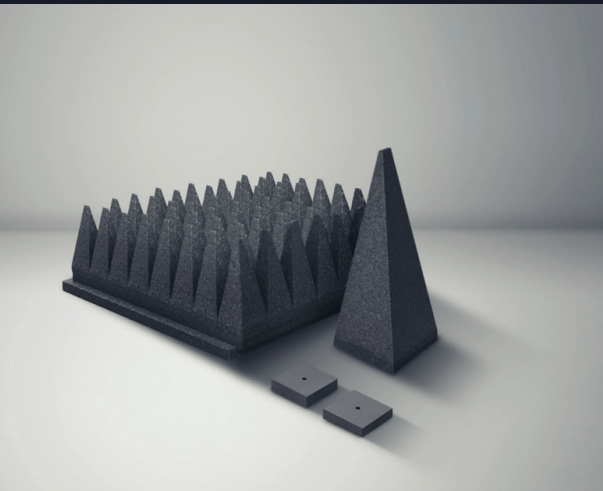
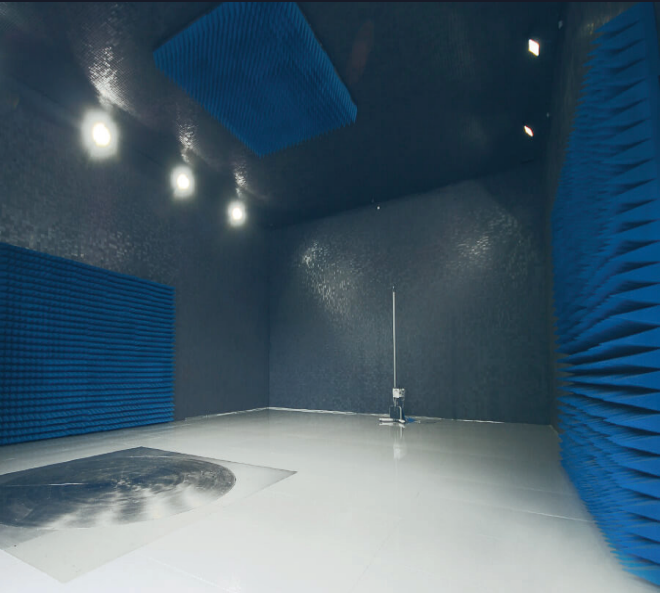

High Performance Anechoic Lining

Ferrite tiles & Absorbers - The walls and ceiling of the test chamber are precisely lined with the latest generation hybrid pyramidal absorbers and ferrite tiles. The Pyramidal absorbers are precisely doped to ensure a smooth transition between the high performance of the Ferrite tiles at lower frequencies to the Pyramidal Absorbers in higher frequencies. The "plug-in" base system of the absorbers means that individual absorber cones can be replaced if accidentally damaged during operation of the test chamber. This reduces the cost of repairs and time taken for the test chamber to become fully operational again.

Pyramidal Absorbers

| Heights | Part Number |
|---------|-------------|
| 450mm | RLT-450 |

Minimum Dimensions

| Length | Width | Height |
|-------------|-------------|-------------|
| Custom Size | Custom Size | Custom Size |

CHOOSE THIS TEST CHAMBER FOR

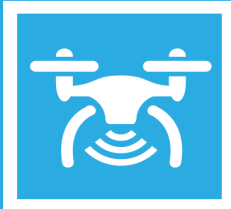

RTCA DO-160

RTCA DO-160 (Aerospace) test procedures; a standard for the environmental test of avionics hardware.



Shield Attenuation

Fully compliant emissions testing to EN 50147-1, a BSI standard for validating shielding effectiveness.



Military Testing

Built to MIL-STD-461 standards for the control of electromagnetic interference (EMI).

DEF STAN 59-411

A dedicated military EMC test facility for the measurement and analysis of conducted emissions susceptibility, radiated emissions, radiated susceptibility and electrostatic discharge.

Military

Specifically relating to UK defence standardisations.

EMC

Electromagnetic compatibility or EMC testing gives the manufacturer of a product the ability to demonstrate the ability of their product.

Test Facility

An EMI/RFI shielded room, using a Faraday cage principle.

This is to stop unwanted signals from the ambient environment entering the chamber and causing interference whilst tests are being performed.

DEF STAN 59-411 MILITARY TEST CHAMBER

Anechoic performance in accordance to DEF STAN 59-411.

1m measuring distance.

Bespoke solution upon request. Test facility can be configured to your exact requirements.

Moulded polystyrene pyramidal hybrid absorbers to all walls, ceiling and partial floor covering. (Absorber coverage as far as physically possible).

Specialist filters are available.

Shield effectiveness to EN50147-1.

Industry-leading low maintenance shielded door with copper beryllium knife edge seals.

Designed and manufactured to the highest standards in Great Britain.

Latest technology high-performance GF 102 ferrite to all walls, ceiling and partial floor covering.

Conductive test bench grounded to the chamber to requirements.

External dimensions to customer requirements*.

Shielded pedestrian door (clear opening)
1000mm (W) x 2000mm (H)*.

Self-supporting steel structure designed to meet industry standards.

Shield modular 2mm steel "pan" shield.

Frequency test range
30 MHz to 18 GHz (40GHz optional).

Floor loading (Standard)
500kg/m²*.

Additional options available including:

Mast, Fire detection, Vehicle Sliding Doors, Air conditioning (HVAC), CCTV, Test benches, Vehicle fume extraction, Whitecaps to absorbers, Lighting, Power, Turntable, Heavy floor loadings, DC Sockets, Filters & Audio Communication.

*All dimensions can be altered upon request (Subject to compatibility).

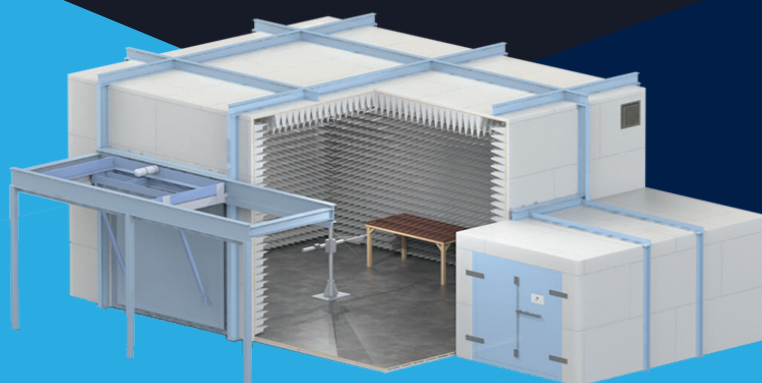

SCAN ME



**MADE in
BRITAIN**